



# PROMATION ENGINEERING

Precision Actuation for Industry  
...Partners, Above and Beyond

Data Sheet

## P2/3 DC Series

On/Off/Jog/Proportional  
ISO5211 F07 8P22

Actuator Specifications	P2		P3	
	800"lbs/90Nm		1335"lbs/150Nm	
Torque lb/Nm	800"lbs/90Nm		1335"lbs/150Nm	
Supply Voltage	12vdc	24vdc	12vdc	24vdc
Max Inrush Current	5.0A	5.0A	5.0A	5.0A
Running Current	3.4A	3.0A	3.4A	3.0A
Runtime (90°)	15sec		22sec	
Weight	25lbs/11kg			
Mechanical Connections	ISO5211 F07 8 pt 22mm			
Electrical Entry	(2) 3/4" NPT			
Electrical Terminations	12 - 18 Ga.			
Environmental Rating	4, 4X			
Manual Override	5" HandWheel			
Control	On/Off/Jog/Proportional			
Duty Cycle	See Graph Below			
Case material	Aluminum Alloy, Powder Coated			
Motor Protection	DC Brush Type			
12/24VDC Operation	275°F/135°C Thermal F Class			
Ambient Temperature Operating Range	-22°F to +150°F -30°C to +65°C			



An electric actuator designed for load requirements ranging from 800 to 1335"lbs. The actuator comes standard with two auxiliary switches (Form C), an internal low power heater, a NEMA 4X environmental rating, and in 12VDC or 24VDC supply voltages. The P2/3 mechanical connections are ISO5211 compliant. The P2/3 DC Series is available as an on/off or two position model that can also be used in bump/jog applications. Additionally, a proportional control is available to accept 0-5vdc, 0-10vdc, 1-5vdc or 4-20mA input signals.

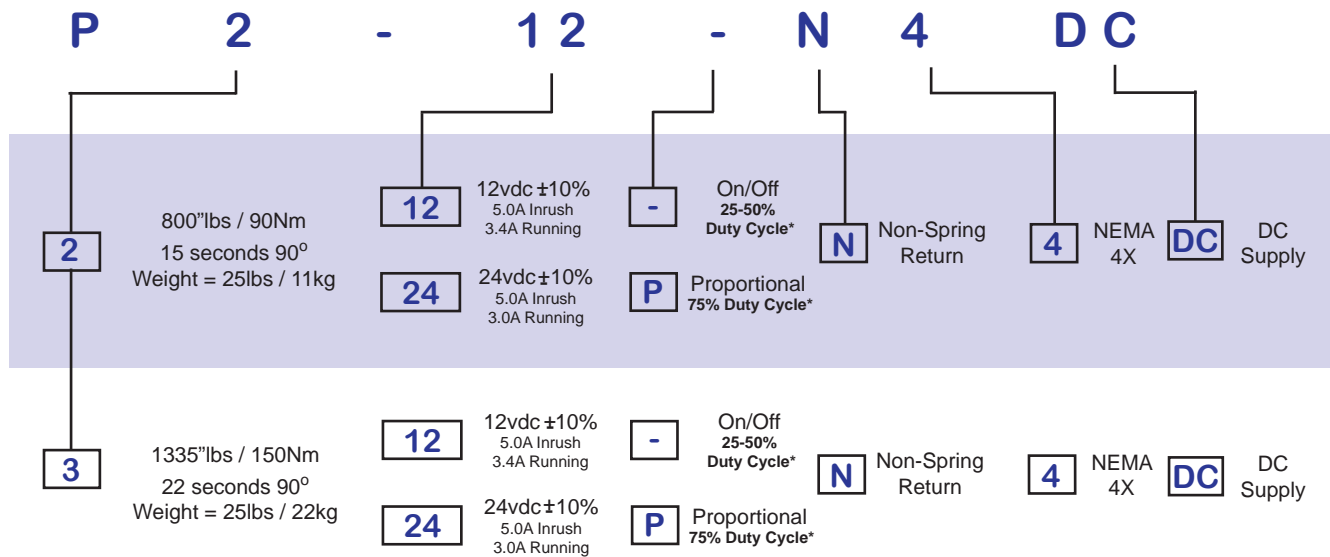

SD08\_P23DCF078P22 Ver A.12.1808

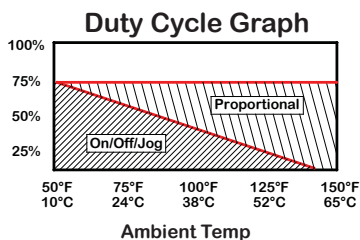

\* Duty cycle is defined as the ratio of run time vs. off time and is a function of ambient temperature. (see graph at left)

See Pg 4 for Options

Also available in 12V & 24V AC operation, 120v & 230v single phase operation, and in 3 phase models for 230/3/60, 380/3/60 & 480/3/60 supplies. Separate spec sheets are available for these configurations.

## Application Notes:

1. These actuators are designed to be used in either a horizontal or upright position.  
Do NOT mount the actuator with the top below a horizontal position.
2. When installing conduit, use proper techniques for entry into the actuator. Use drip loops to prevent conduit condensate from entering the actuator.
3. Both NPT conduit ports MUST use proper equipment to protect the NEMA 4x integrity of the housing.
4. The internal heater is to be used in ALL applications.
5. Do NOT install the actuator outdoors or in humid environments unless it is powered up and the heater is functioning.
6. Use proper wire size to prevent actuator failure (see chart below for proper wire sizing).
7. Mechanical travel stops are factory calibrated for 90 degree operation. These stops are NOT designed to adjust mechanical rotation by more than +/- 3 degrees.

## P2/3 Series Dimensional Data

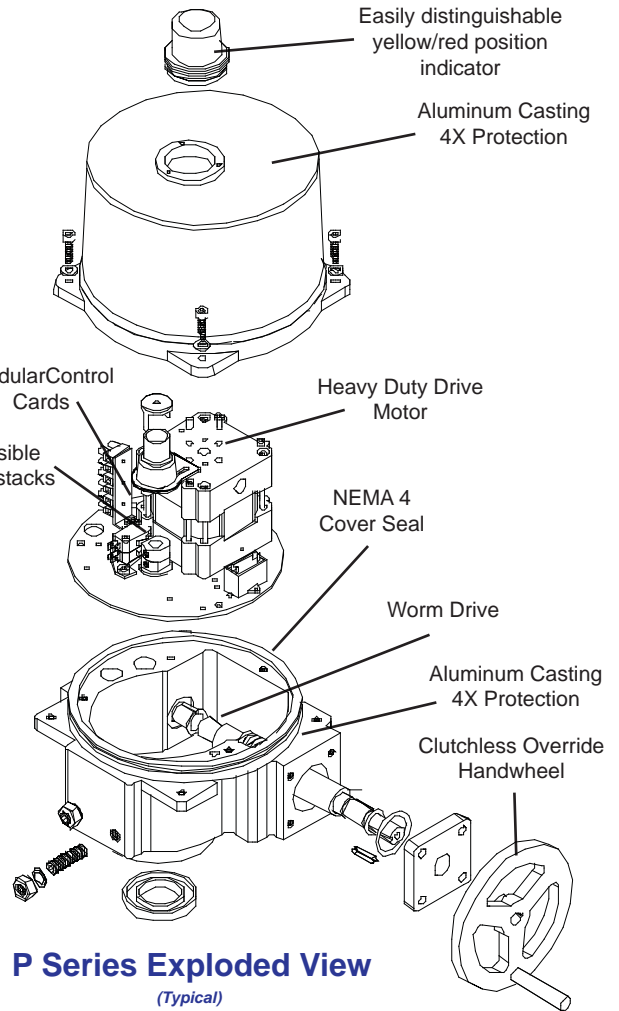
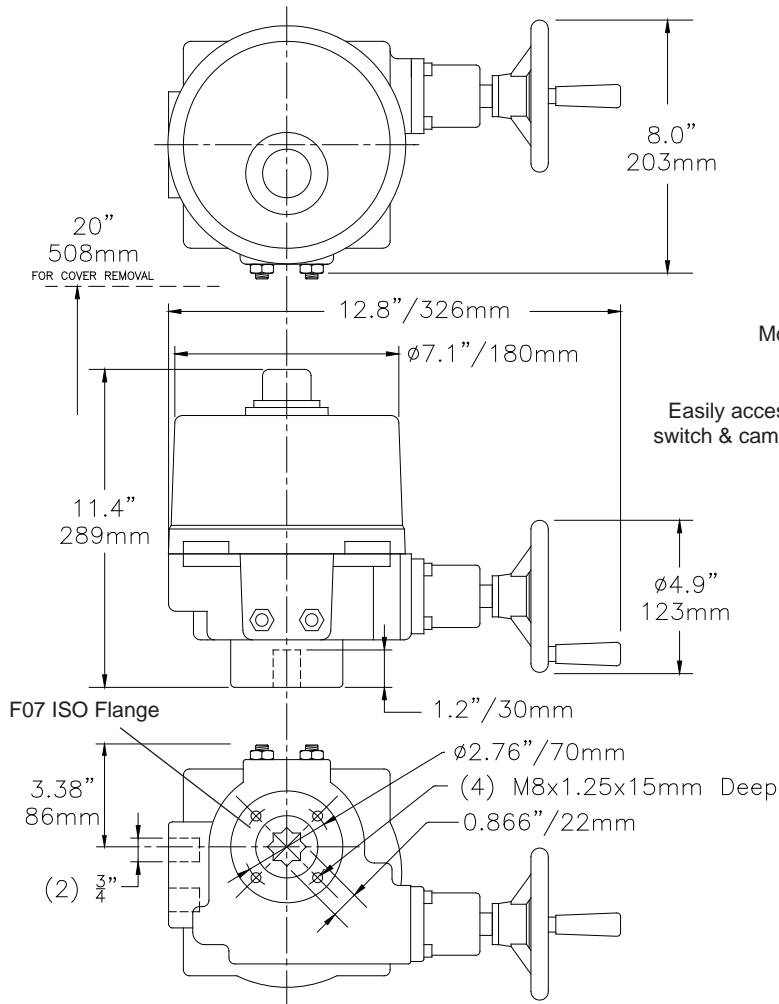

Wire sizing data is provided in the table below to assist in the selection of the proper wire size for ProMation P2/3 series actuators using various wire sizes over distance. Please make sure to reference the correct voltage and do not exceed the indicated length of the wire run for each model.

## Wire Sizing Data

Wire Gage	MAX distance between Actuator and Supply (feet)	
	P2/3-12DC 5.0A	P2/3-24DC 5.0A
18		
16	26	52
14	42	84
12	64	128
10	109	218
8	163	326

Switch sequencing data is provided in the table below to show the change-of-state points during the rotation of the actuator from OPEN to CLOSED and back again. Switches for terminals 3 thru 6 are set at the factory and should NOT be changed. The INCLUDED auxiliary switches SW3 & SW4 are for terminals 7 thru 12 and those setpoints may be modified if need be. When so optioned, SW5 & SW6 auxiliary switches are initially set to function the same as auxiliary switches SW3 & SW4.

## Switch Logic Map and Switch/Cam Arrangement

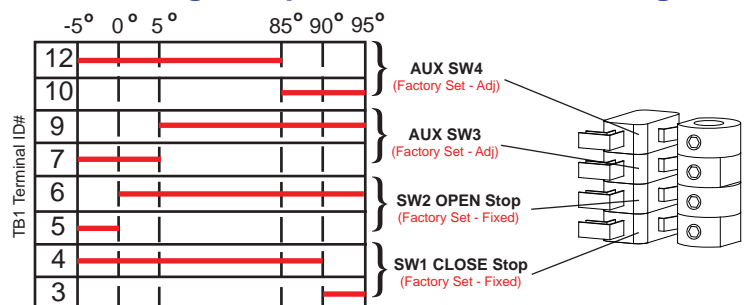

# Wiring Diagrams for P Series -

## On/Off/Jog Control

Field Control Device may be relay contact or switch type. Pilot device 10A MAX. Auxiliary switches are rated 10A @ 250vac MAX. Terminals 7-12 are dry type Form C. Terminals accept 12-18ga solid/stranded wire.

12vdc shown, 24vdc similar

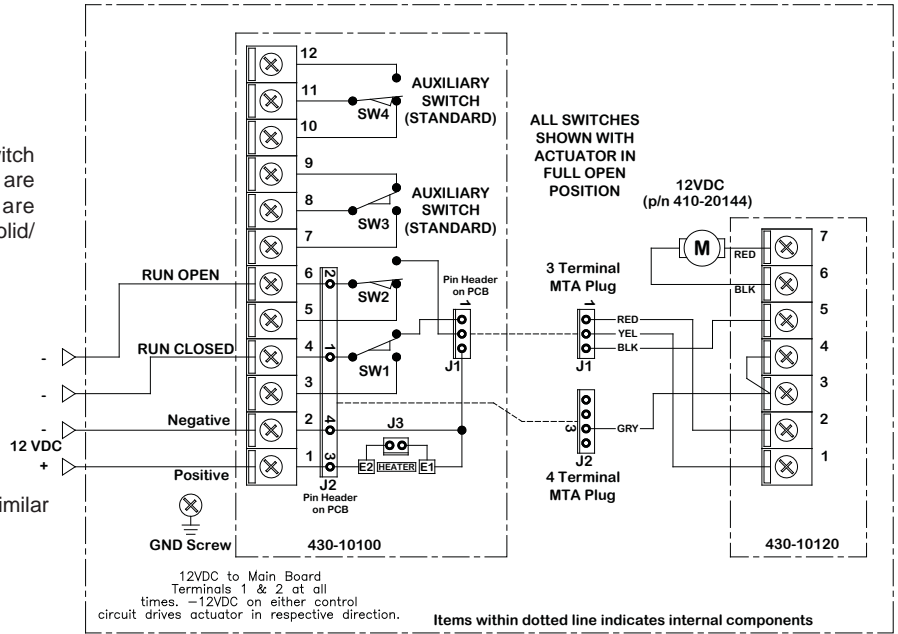

## Proportional Control

Control Signal Inputs (selectable):  
0-5vdc, 0-10vdc, 1-5vdc, 4-20mA

Common can be ground referenced or isolated from ground.

Input impedance: 20k ohms (0-10vdc)  
10k ohms (0-5vdc)  
250 ohms (4-20mA)

Feedback Signal Output: 4-20mA  
Referenced to the common terminal.  
Max Load: 500 ohms

Control Card Fuse: 8A Bussman ABC-8

Control Adjustments:  
Zero: Adjustable through full range  
Span: Adjustable through full range  
Deadband: Linearly adjustable through range

Main Switch Card Terminals accept 12-18ga solid/stranded wire.

Proportional Control Card Terminals accept 14-22ga solid/stranded wire.

(24vdc shown, 12vdc similar)

Signal IN +  
4-20mA +  
FB Out -

GND Screw

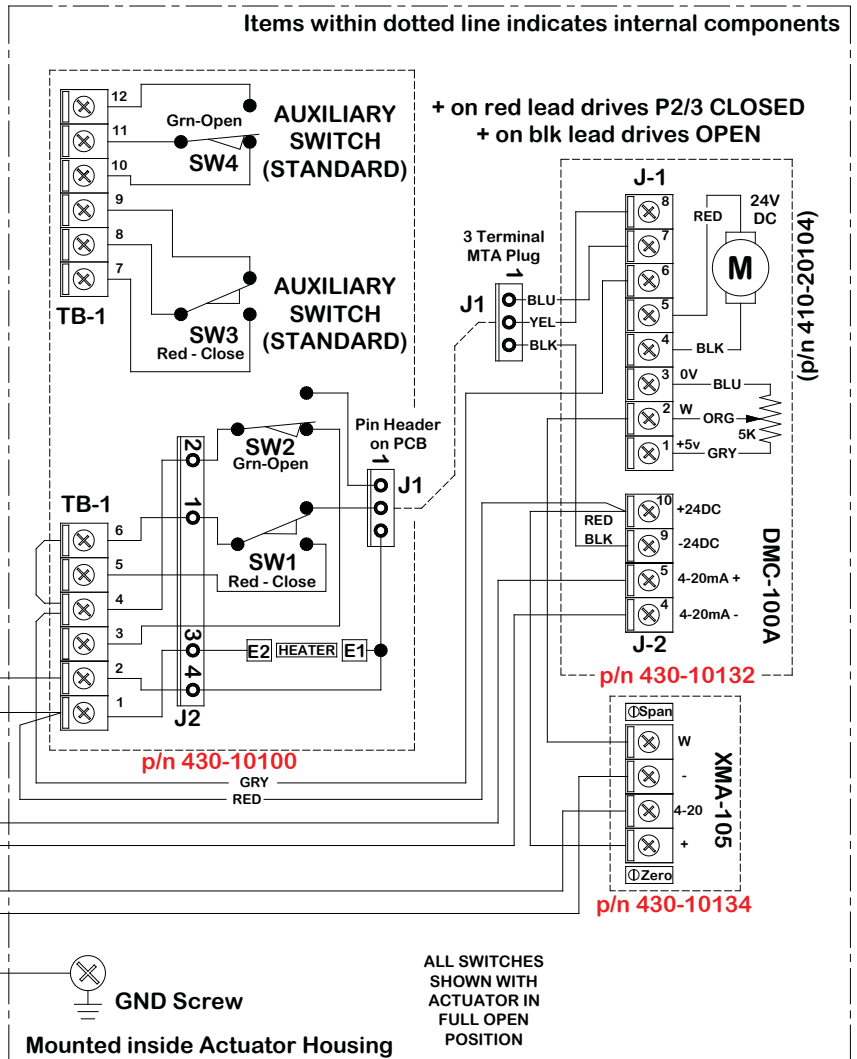

SD08\_P23DCF078P22 Ver A.12.1808

## Local Control Options



**LA**

Basic Version  
No indicator lamps  
No remote status outputs  
No aux switch pass-through

**LB**

Mid-Level Version  
2 status indicator lamps  
2 status HOT outputs  
No aux switch pass-through

**LC**

Full Version  
4 status indicator lamps  
Remote status monitoring  
Aux switch termination block

## Chain Wheel Options

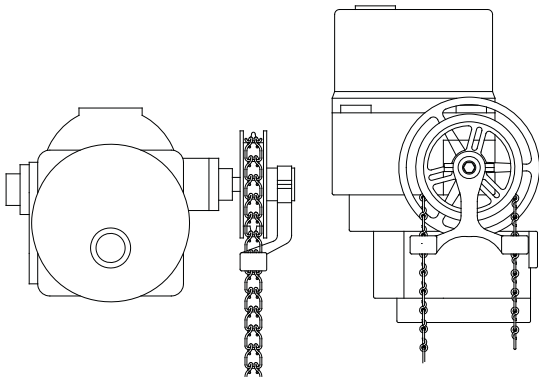

The **C Option** is a mechanical Chain Wheel system that converts the manual override handwheel to a chain driven override for use in applications where the actuator is mounted at a distance above the floor. (Must be used with one of the above Local Control Options, see the options guide for details).



**PROMATION  
ENGINEERING**

*Precision Actuation for Industry*

## +2 Auxiliary Switch Option

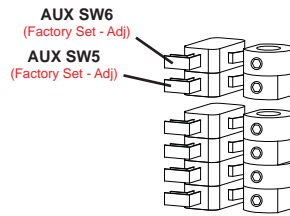

Switch/Cam  
Arrangement

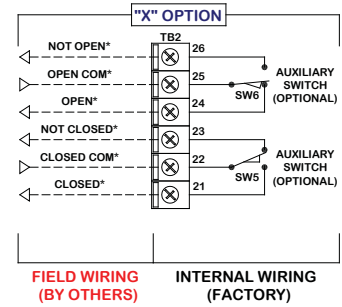

The **X Option** consists of 3rd & 4th auxiliary switches factory mounted. This is NOT a field installed option. This option can be used with On/Off and Proportional control actuators. It is available on P2 thru P13 series actuators, and must be ordered with actuator.

## Potentiometric Feedback Option

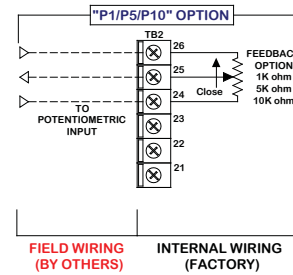

The **P# Option** is a potentiometric feedback for On/Off actuators. This is NOT a field installed option. This option can be used only with On/Off actuators. It is available on P2 thru P13 series actuators. This option requires the selection of 1k, 5k or 10k ohm resistance values, and must be ordered with actuator.

These tables indicate which options are available in On/Off and Proportional control actuators, as well as which options are compatible with each other.

Proportional Options Compatibility			
	C	L	X
C	-	yes	yes
L	yes	-	yes
X	yes	yes	-

On/Off Options Compatibility				
	C	L	X	P1,5,10
C	-	yes	yes	yes
L	yes	-	yes	yes
X	yes	yes	-	n/a
P1,5,10	yes	yes	n/a	-